



**KING COUNTY**

1200 King County Courthouse  
516 Third Avenue  
Seattle, WA 98104

**Signature Report**

**April 30, 2002**

**Motion 11416**

**Proposed No.** 2002-0138.1

**Sponsors** Pullen and Phillips

1           A MOTION confirming that the conservation futures  
2           matching fund requirement is met for the city of Enumclaw  
3           Newaukum creek/Big Spring creek conservation futures  
4           acquisition project by the value of conservation easement  
5           lands exchanged with project partner King County.

6  
7

8           WHEREAS, conservation futures tax levy funds are collected through  
9           King County as a dedicated portion of the property tax and are, by statute,  
10          available only for the acquisition of open space and natural resource lands, and

11          WHEREAS, Ordinance 13717 established a process for the annual  
12          distribution of conservation futures tax levy funds, which includes an allocation  
13          of conservation futures funds by the council after receiving a recommendation  
14          from the conservation futures citizens committee, and

15          WHEREAS, on September 24, 2001, the King County council adopted  
16          Ordinance 14213 and allocated four hundred sixty thousand dollars in

17 conservation futures funds to the city of Enumclaw's 58.25-acre Newaukum  
18 creek/Big Spring creek acquisition project, and

19 WHEREAS, the county desires to disburse conservation futures funds to  
20 the city of Enumclaw and must do so by executing a new interlocal agreement  
21 with the city, and

22 WHEREAS, the city has requested confirmation that it may meet the  
23 matching funds requirement of Ordinance 13717 through a partnership with  
24 King County, whereby King County purchases adjacent habitat lands on Big  
25 Spring creek and exchanges with the city conservation easements on the  
26 adjacent county lands for a conservation easement on the 58.25-acre city  
27 property, with the value of the county easements credited towards the city's  
28 conservation futures match obligation;

29 NOW, THEREFORE, BE IT MOVED by the Council of King County:

30 The council confirms that the conservation futures matching fund requirement is  
31 met for the city of Enumclaw Newaukum creek/Big Spring creek conservation futures  
32 acquisition project by the value of conservation easement lands exchanged with project  
33 partner King County, whereby the cash value of adjacent habitat lands on Big Spring  
34 creek purchased by King County may be credited towards the city's match obligation,

35 provided that King County and the city exchange conservation easements over all lands  
36 subject to the match requirement.

37

Motion 11416 was introduced on 4/1/2002 and passed by the Metropolitan King County Council on 4/29/2002, by the following vote:

Yes: 12 - Ms. Sullivan, Ms. Edmonds, Mr. von Reichbauer, Ms. Lambert, Mr. Phillips, Mr. Pelz, Mr. McKenna, Mr. Constantine, Mr. Pullen, Mr. Gossett, Mr. Irons and Ms. Patterson  
No: 0  
Excused: 1 - Ms. Hague

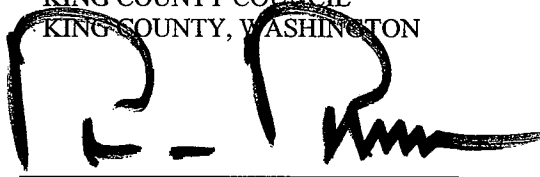
KING COUNTY COUNCIL  
KING COUNTY, WASHINGTON  

For Cynthia Sullivan, Chair

ATTEST:

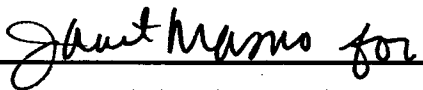
  
Anne Noris, Clerk of the Council

Attachments      A. Newaukum Creek - Big Spring Creek Map, B - Big Spring Creek Map

Attachment A

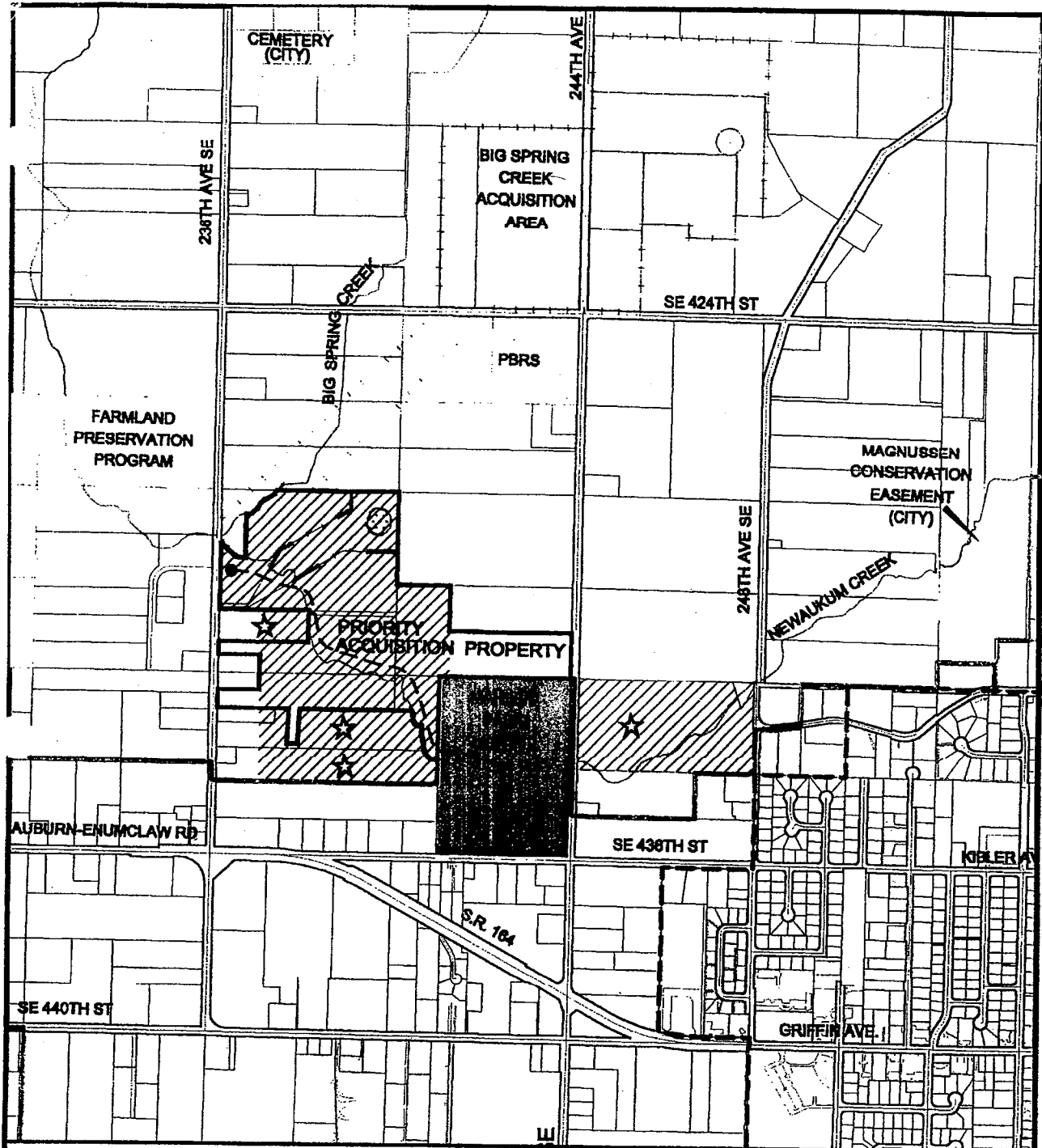

<b>LEGEND</b>		<b>NEWAUKUM CREEK/BIG SPRING CREEK</b>	
<b>Existing:</b>		<b>PRIORITY FOR FEE ACQUISITION: 58.25 ACRES</b>	
	Public Park	<b>SCALE IN FEET</b>  1 inch = 1000 feet 1:12000	
	Other Permanent Open Space	<b>Proposed:</b>	
	Big Spring Creek Acquisition Area Stream		Priority for Fee Acquisition
	Ditch		Candidates for Additional Fee/CE Acquisition
	Open Water		Wetland Area Proposed for Restoration
	Parcel Boundary		Proposed Trail
	Enumclaw Municipal Boundary		Proposed Parking
	Enumclaw Urban Growth Boundary		

HR02111416.D

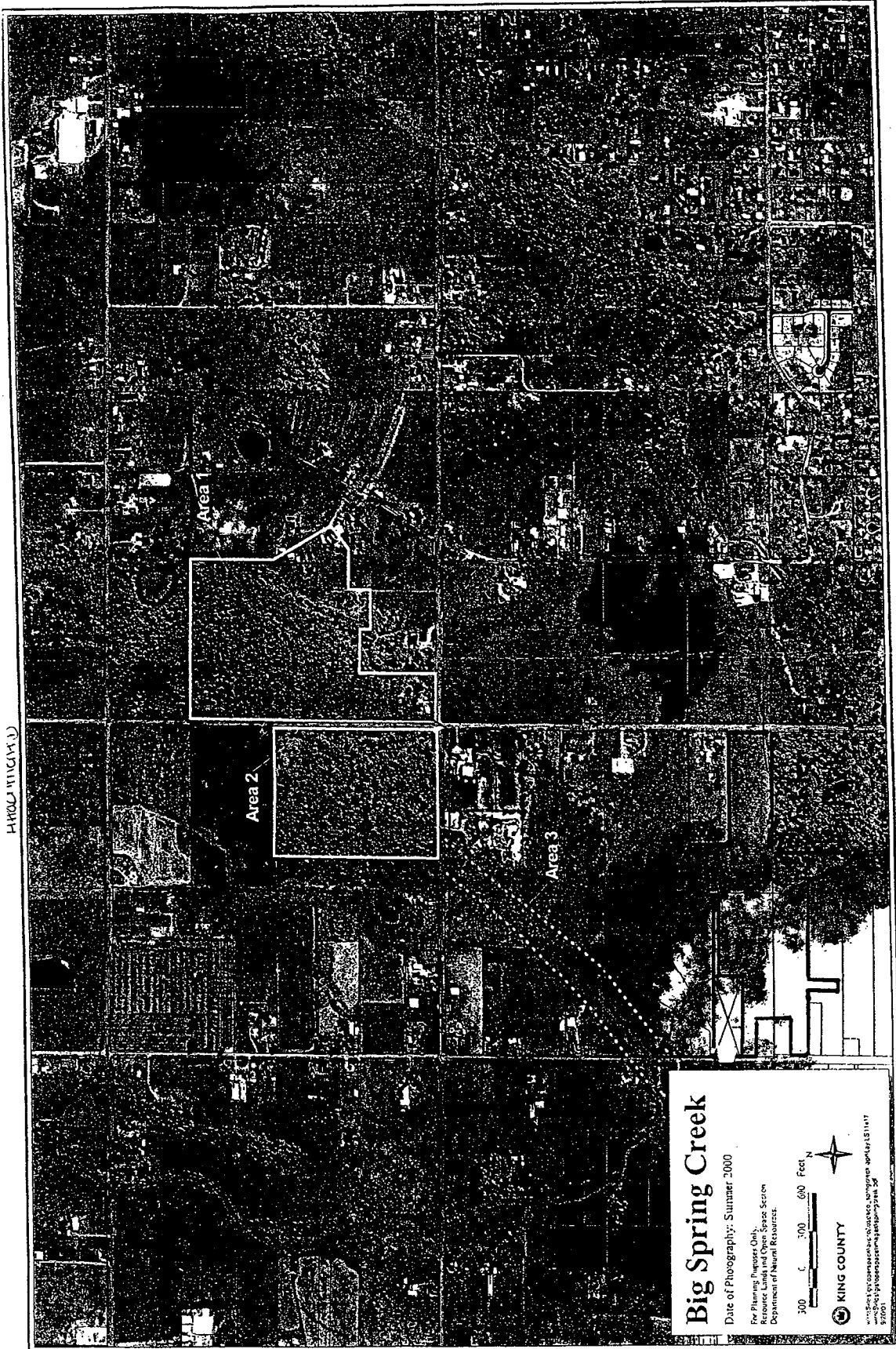

# Big Spring Creek

Date of Photography: Summer, 2000

For Planning Purposes Only.  
Resource Lands and Open Space Screen  
Department of Natural Resources.

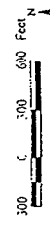

KING COUNTY

www.kingcounty.gov/department/naturalresources  
97201